

SPT. NO. 68-69-70-71-72-74-75-77-78-79-81-82
FRAME NO " " " " " " " " " " " "

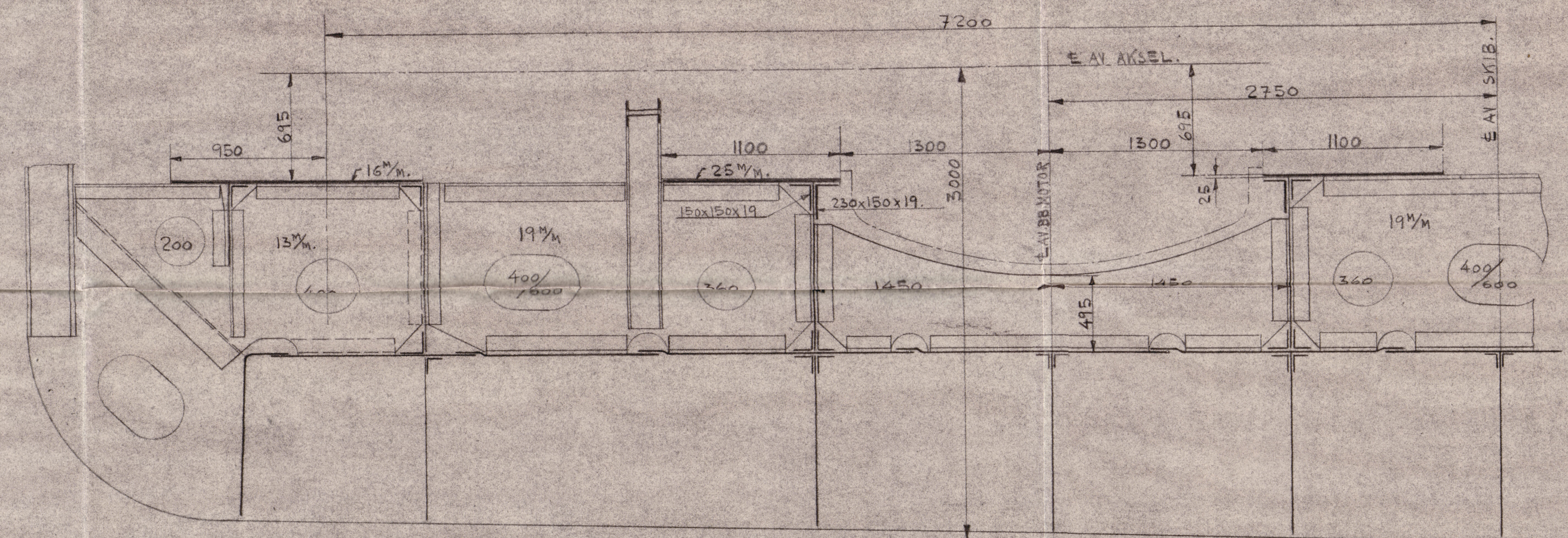

SPT. NO. 73-80
FRAME NR. 73-80

RIVETING AS BEFORE
EXCEPT AS SHOWN IN SECTION ABOVE.

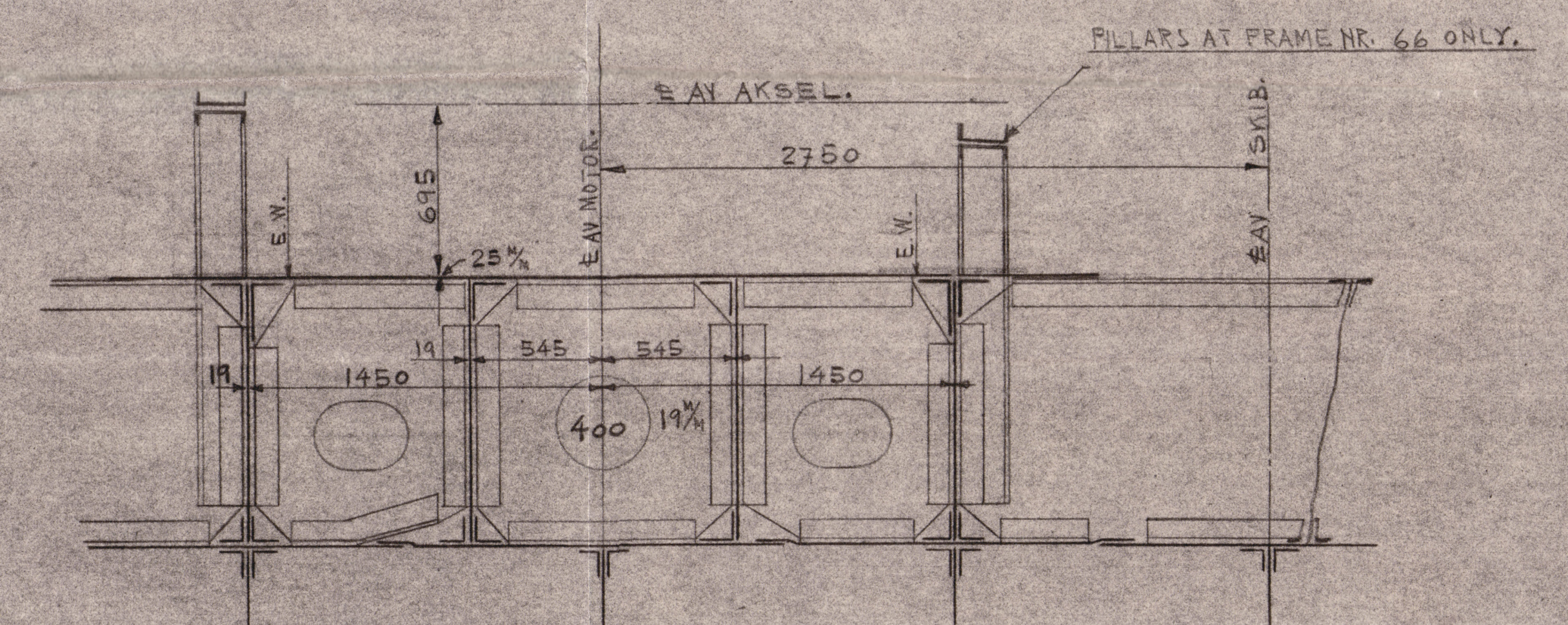

THRUST FUNDAMENT SPT. NO 65-66-67.



22 YEARS - NEW - YEARS OLD
M/S BENJAMIN FRANKLIN
ENGINE - SEATING & THRUST BLOCK
19-10-26
Lloyds Register
S4992

W340-0061