

Qualité des matériaux

Resistance des tôles d'enveloppes	43 à 50 ^{kg}	Shells plates	Base Strength	Elongation
Resistance des autres tôles	41 à 46 ^{kg}	Chas plates	27.5 - 31.5 tons	20. %
Resistance des tirants	42 à 45 ^{kg}	Longitudinally stays	26. - 29.5 tons	20. %
Resistance des rivets et entretoises	41 à 47 ^{kg}	Rivets of screw stays	26. - 30 tons	20. %
Élongement minimum des tôles, tirants, etc. sous de 20 % sur une éprouvette de 0.7500		The elongation minima of the plates, stays etc. wide bar of 20 % on a sample of 8" length.		

Quality of materials

Compagnie Maritime Peninsulaire Cargo-boat "Ville d'Alger"

Chaudière

Echelle 1/10^m

11/10/11

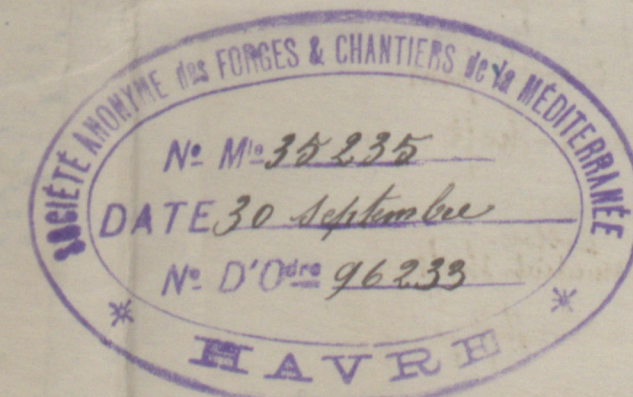

Enveloppement de la chaudière en tôle d'acier 11.25
112 divisions de 91.25 = 5.82

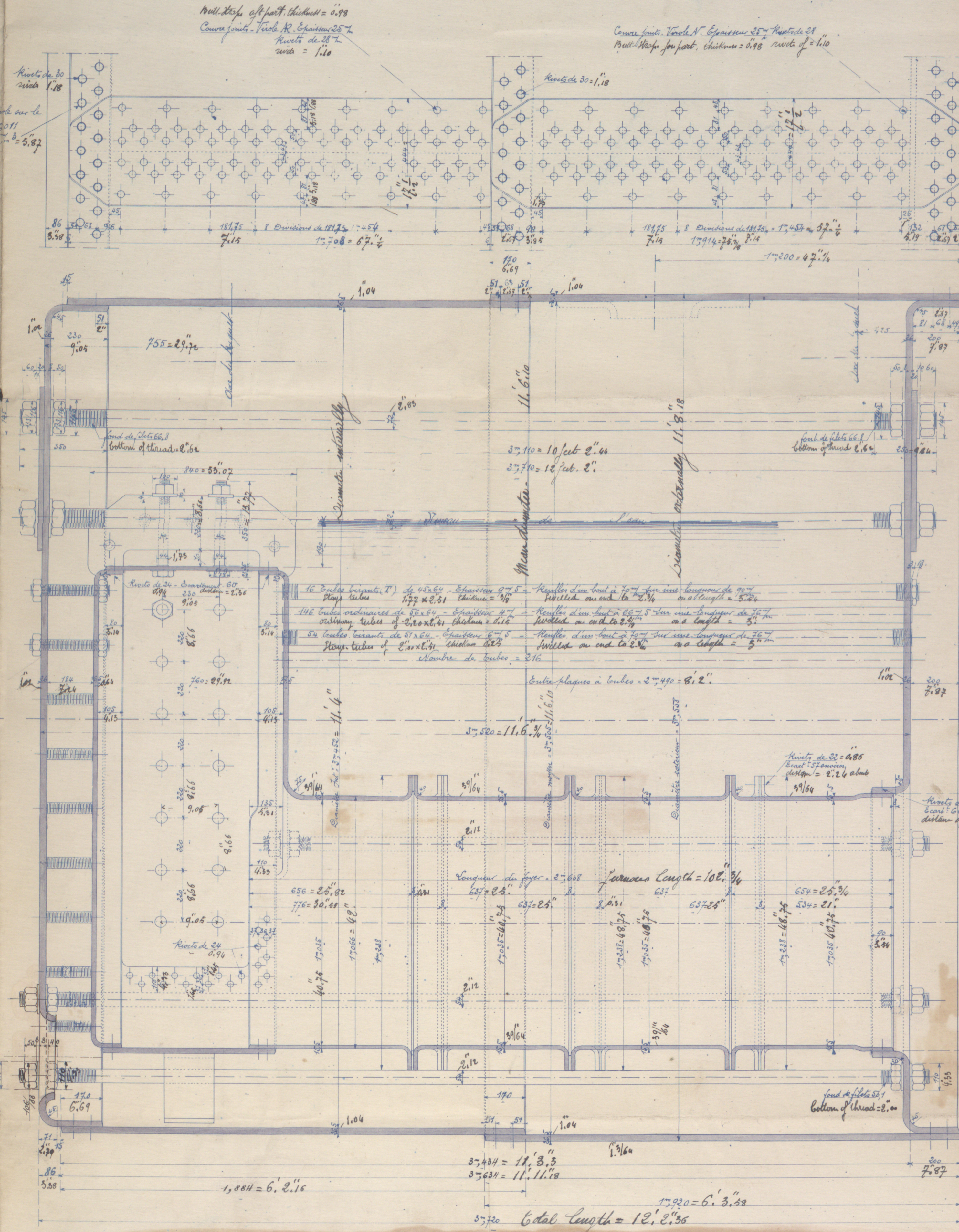

Nota - Les screw stays on the margin plates have diameter externally 1.889, in the bottom of thread 1.795. The others are 1.795. Rivets externally 19 in the bottom of thread 1.89.

APR 10.10.11

Surface de chauffe extérieure (chaudière)	1.89 ^m	Working pressure = 18.5 ^{kg} per sq. inch
Surface de grille	5.20 ^m	total heating surface = 4178.5 sq. feet
Tolérance d'eau	15 ^m 6.50	total grate surface = 106.8 sq. feet
Tolérance de vapeur	7 ^m 3.50	
Nombre de chaudières par bateau	3	Number Main Boilers = 3. Simple

Ex. Local draft (Korndorff system) will be fitted.

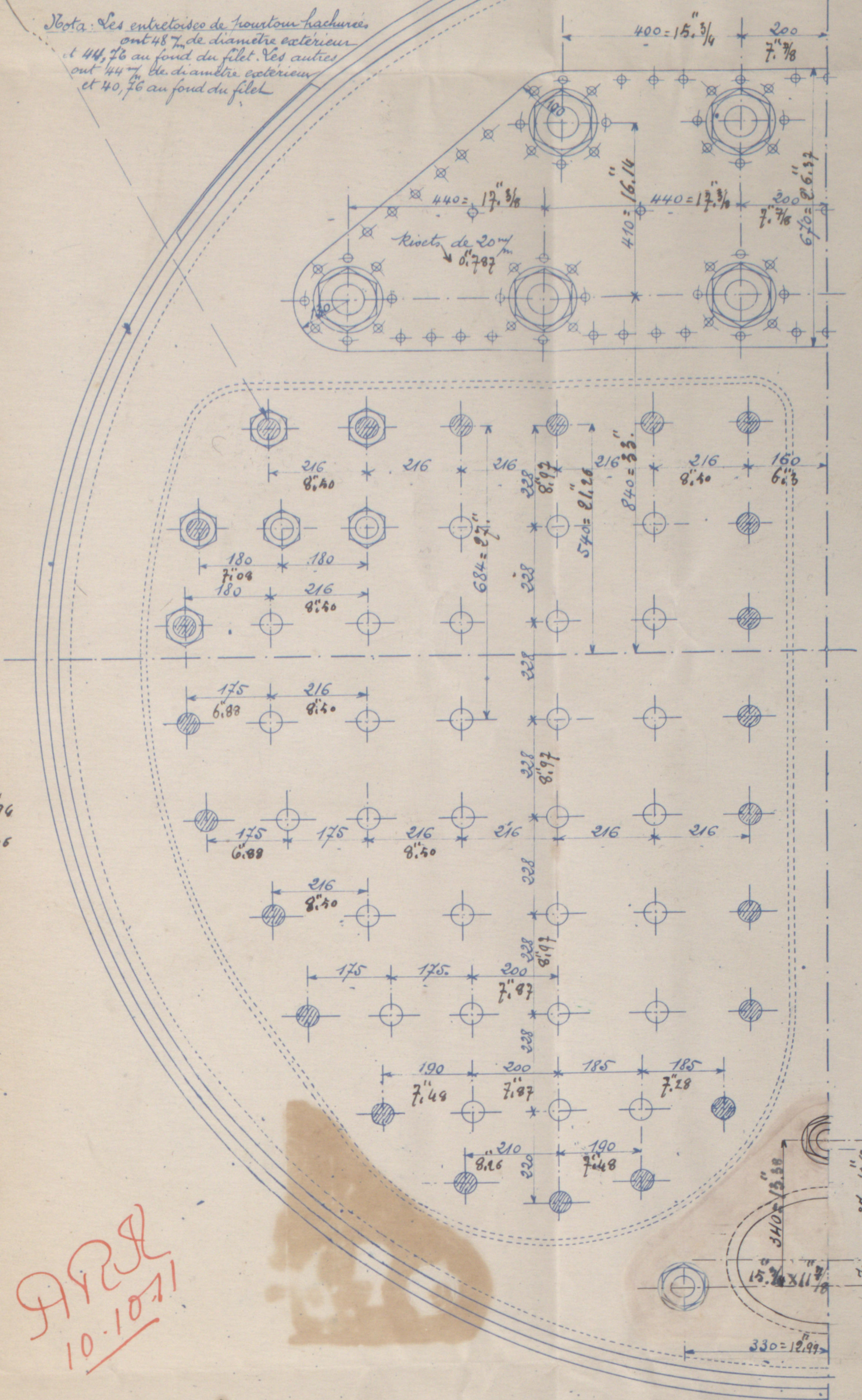

HAVRE, LE 4 Octobre 1911
L. Ingénieur en Chef

Plan of Main Boilers (3) proposed to be built by the Forges & Chantiers de la Meuse, intended for the Cargo-boat "Ville d'Alger" to the order of the Compagnie Maritime Peninsulaire, at Havre.

Submitted for approval
Havre 7th Oct 1911
J. Carter

RETAIN

Compagnie Havraise Peninsulaire
Cargo-boat - "Ville d'Alger"
Chaudière

W705-0156

*Plan of Main Boilers (3) proposed to be built
by the "Forges & Chantiers de la Méditerranée" Havre, intended
for Steamer "Ville-d'Alger", to the order of the
Compagnie Havraise Peninsulaire, at Havre.*

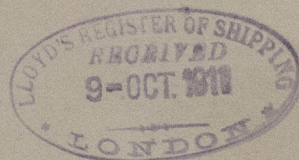

© 2021

Lloyd's Register
Foundation